

DropSafe™
safety pen needles

Safer drug delivery for clinicians with the
first & only 31G x 5mm
safety pen needle with covered tip¹



Safer drug delivery for clinicians with the first & only 31G x 5mm safety pen needle with covered tip!

May 23, 2022

DropSafe Safety Pen Needle is now available in 31G x 5mm, making it the ***shortest & thinnest safety pen needle with a covered needle*** on the market¹!

- Data shows that despite current safety programs, medication injections account for 26% of needlestick injuries (NSI)².
- Both clinicians & patients are at risk of a bilateral exposure from an avoidable NSI event, when devices with longer length needles requiring a pinch-up technique are used.
- Devices designed to minimize NSI risk with shorter needles & passive safety technology are critical to protect clinicians, with Safety Pen Needles proven to be the safest option for drug delivery.^{3,4}

With a shorter 5mm needle, clinicians may forgo the pinch-up technique when using DropSafe, thereby reducing the risk of a bilateral exposure^{6,7,*}.

DropSafe Safety Pen Needles have proprietary passive technology, which require no additional steps to activate the safety mechanism. In a clinical study, **clinicians had a 100% success rate in performing injections with 0% failures when using DropSafe⁵.**

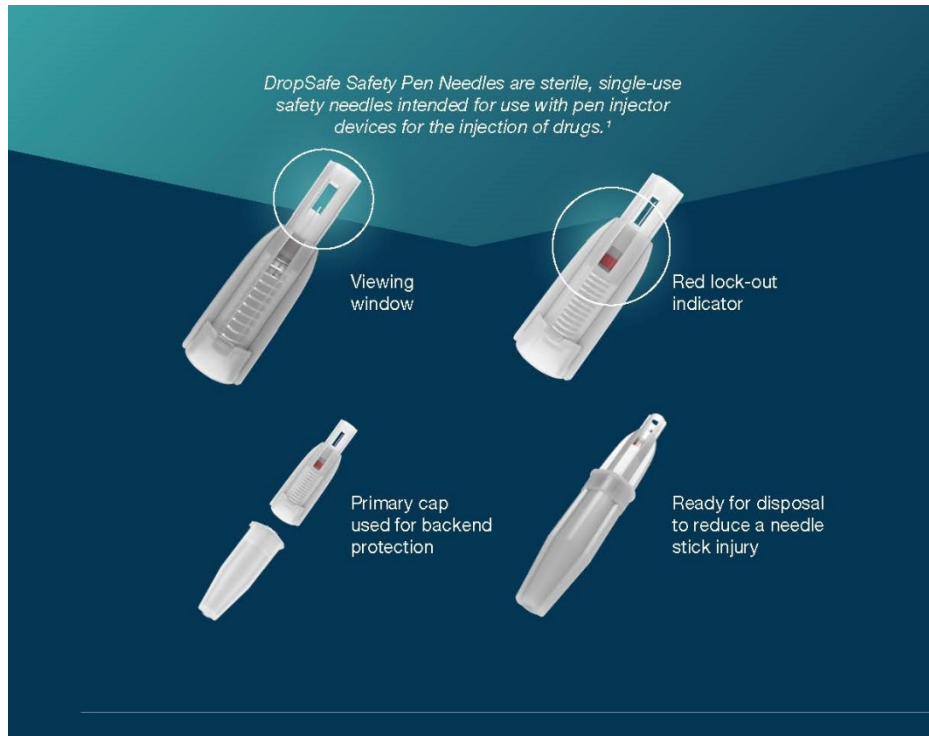

How does the DropSafe passive safety mechanism work?

DropSafe has a unique and proprietary built-in sharps injury prevention feature (SIPF). DropSafe was specifically designed to minimize the risk from accidental needlesticks by application of the SIPF.⁵

100% of evaluators agreed that the “injection is easy” with DropSafe.⁵

- The viewing window enables the user to check if the needle is visible.
- The shield serves to hide the needle from the patient, both before and after the injection.
- After use, the needle is automatically locked out (passive mechanism), confirmed by a red lock-out indicator.
- Ready for disposal to reduce a needle stick injury

Caution: Avoid infections. Before administering an injection, clean and disinfect the injection site. Do not use if the seal or needle is damaged, missing, or if the shield or outer cap appears to be damaged. Discard the used safety pen needle into a sharps container.

DropSafe safety pen needles have proven compatibility with a large majority of insulin pens currently available.

HTL-Strefa is a world leader in developing, producing, and supplying products for drug delivery, immunizations, and capillary blood sampling, with a core expertise in safety sharps. It is widely

recognized as the inventor of the “safety lancet” product category, producing over 50% of safety lancets worldwide.

For more information, visit our website at <https://dropsafe.info/products/dropsafe-safety-pen-needles/>

Ordering information	MFR #	NDC #	Product Size	Quantities
	8161	08489-8161-10	31G × 5mm (0.25mm × $\frac{3}{16}$ "*)	100 pieces / box
	8162	08489-8162-10	31G × 6mm (0.25mm × $\frac{1}{4}$ "*)	2,000 pieces / case
	8163	08489-8163-10	31G × 8mm (0.25mm × $\frac{5}{16}$ "*)	

References:

1. Data on File. As of 02.01.2022 of marketed safety pen needles in the US. 2. International Safety Center. EPINet Report for needlestick and Sharps object injuries. 2019. 3. Grissinger M. Avoiding problems with insulin pens in the hospital. P&T. 2011; 36(10):615-616. 4. Costigliola V, Frid A, Letondeur C, Strauss K. Needlestick injuries in European nurses in diabetes. Diabetes & Metabolism. 2012; 38:S9-S14. 5. Malinowski M, Serafin A, Prazmowska- Wilanowska A. DropSafe safety pen needle helps to prevent accidental needlesticks after injections: results of a simulated clinical study. Journal of Infection Prevention. 2020; ePub 1 September 2020: <https://doi.org/10.1177/1757177420948580>. 6. Black L. Ditch the pinch: bilateral exposure injuries during subcutaneous injection. American Journal of Infection Control. 2013; 41: 815-819. 7. Frid A, Hirsch L, Gaspar R, et. al. New injection recommendations for patients with diabetes. Diabetes Metab. 2010;36 Suppl 2:S3-S18. 8. Bossi AC, Veronesi G, Poerio CS, et al. A prospective study for introducing insulin pens and safety needles in a hospital setting. The SANITHY study. Current Diabetes Reviews. 2016; 12:460-467.

Disclaimer: *Select patients may require a pinch up technique or a 45° angle injection with a 5mm needle.